

INSTALLATION INSTRUCTIONS

DESCRIPTION: Saddlebag Kit
PART NUMBER: 1RC-F84H0-V0
MODEL: FZ-09 (FZ09)



WARNING

Please read and understand these instructions completely before installation to avoid possible injury, or damage to the accessory or vehicle.

WARRANTY INFORMATION:

Genuine Yamaha accessories are covered by a 1-year limited warranty against defects in material or workmanship. Labor for replacement of defective components is not covered. See your Yamaha dealer for a copy of the warranty statement.

REQUIRED PARTS NOT INCLUDED IN THIS KIT:

This accessory requires:

- **Yamaha Saddlebag Mount Kit (1RC-G8460-V0)**

See your Yamaha Dealer for more information.

DEALER OR INSTALLER:

These instructions contain important information for future reference and *must* be given to the customer.

PARTS LIST:

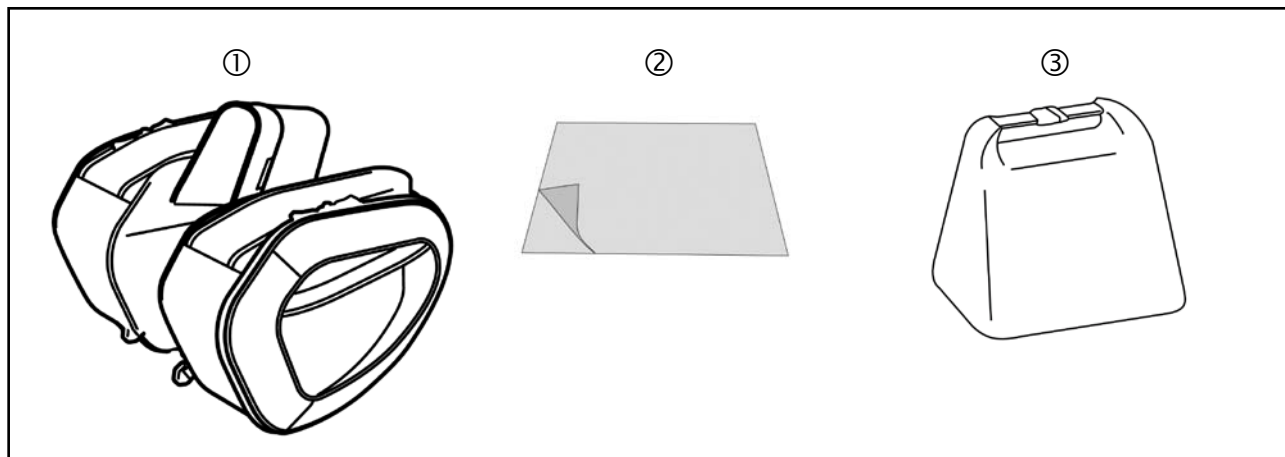

No.	Part Number	Description	Qty
--	1RC-F84H0-V0		--
1	*	Saddlebag set	1
2	*	Protective tape sheet	2
3	*	Saddlebag liner	2

* Part supplied with kit only and not available separately.

PREPARATION:

1. Stand the motorcycle on a secure and level surface.
2. Clean all mounting surfaces before beginning installation.

INSTALLATION:

1. Trim and fit the protective sheet ② to any area where the saddlebags may scratch or contact a painted surface (Fig. 1).

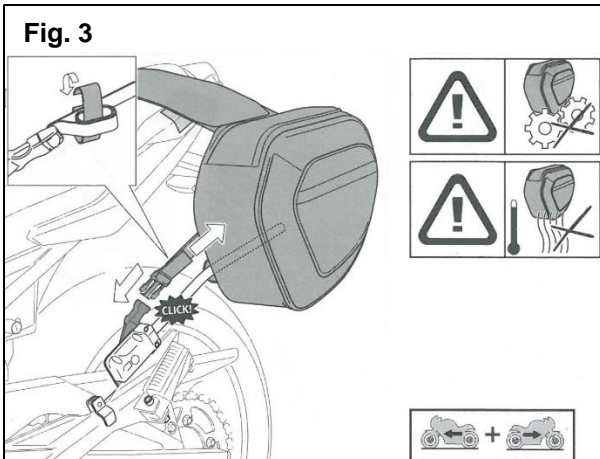
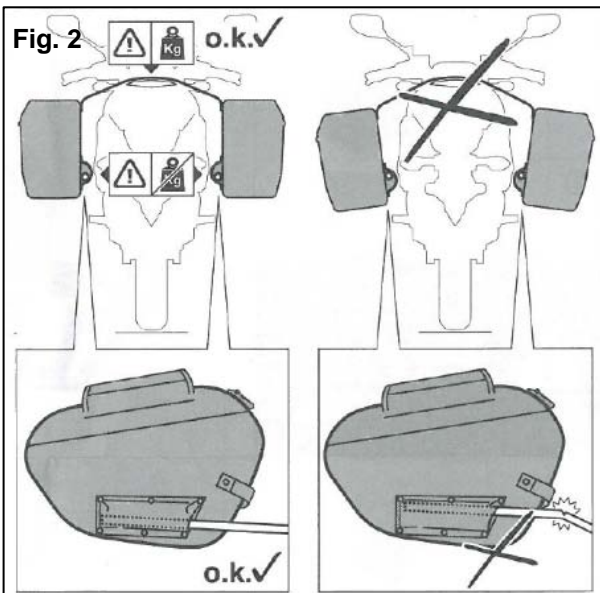
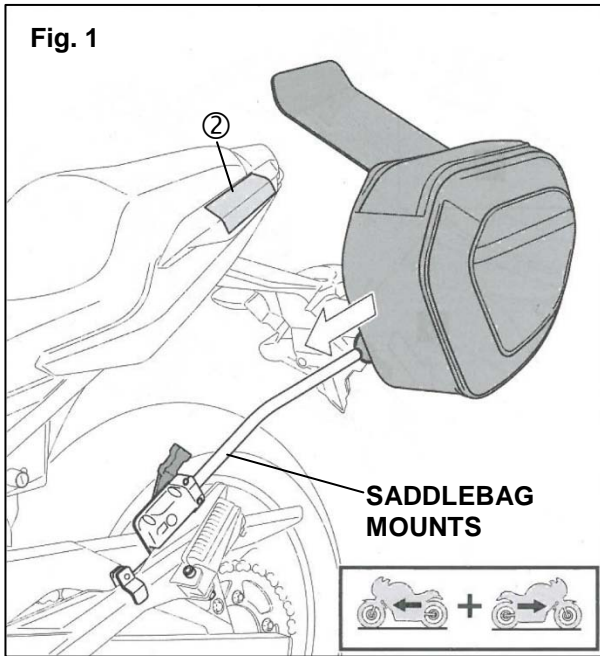

- Slide saddlebags over the mounting pipes and adjust the yoke so that the weight is carried on the seat, not the mounting pipes (Fig. 2).
NOTICE: The mounting pipes can break if they support any cargo weight. All weight should be on the seat.
- Secure the saddlebags to the mounts, connecting the buckles and taking up any slack in the straps. Secure and tie up any extra strap (Fig.3).

⚠ WARNING

Improper loading can adversely affect handling.

- Do not exceed maximum load limit: 5 kg (11 lb) each saddlebag.
- Distribute weight evenly from side to side.
- Read the Owner's Manual for important loading and tire pressure information.
- Total weight of rider, passenger, accessories, and cargo must not exceed the motorcycle load capacity shown in the Owner's Manual.
- Never ride above 120 km/h (80 mph) with saddlebags because handling could be affected. This maximum speed may be reduced by such factors as improper loading, poor tire or overall motorcycle conditions, poor road surfaces, or adverse weather conditions.
- Do not allow saddlebags or straps to contact any moving parts. Check accessory mounts and cargo restraints frequently.

NOTICE:

- Do not allow the saddlebags or straps to contact hot exhaust or engine parts.
- Do not carry sharp objects or liquids.

MAINTENANCE:

Periodically check all hardware and straps for tightness and re-adjust as necessary.

CARE AND CLEANING:

Surface wash using a mild soap and water solution and soft cloth.

CUSTOMER SERVICE:

For further information see your Yamaha dealer.

ESTIMATED TIME TO INSTALL: 0.2 HRS